

寄件者  
寄件日期: 2025年02月13日星期四 16:55  
收件者: tpbpd/PLAND  
主旨: S.16 Application No. A/YL-KTN/1096 - Submission of Supplementary Information  
附件: KTN1096\_P21071\_SI\_13.2.2025.pdf  
郵件標幟: 待處理  
標幟狀態: 已完成  
類別: Internet Email

*Your Ref.: A/YL-KTN/1096*

Dear Sir/Madam,

Attached please find our supplementary information for the captioned s.16 planning application. Hard copy will be delivered to the Board.

Regards,  
Janice Tang

--

Your Ref.: A/YL-KTN/1096

Our Ref.: P21071/TL25044

13 February 2025

The Secretary  
Town Planning Board  
15/F., North Point Government Offices  
333 Java Road, North Point, Hong Kong

By Post and E-mail  
tpbpd@pland.gov.hk

Dear Sir,

**Submission of Supplementary Information**

**Proposed Temporary Warehouse (excluding Dangerous Goods Godown)  
with Ancillary Office for a Period of 3 Years and Associated Filling of Land  
in "Agriculture" Zone, Lot No. 1376 RP in D. D. 109,  
Yuen Long, New Territories  
(Application No. A/YL-KTN/1096)**

We would like to rectify the layout of the captioned application. The development parameters remain unchanged. We enclosed the revised Layout Plan (**Plan 3a**), Plan showing the Area of Site has been paved (**Plan 4a**) and Swept Path Analysis (**Plan 5a**) for your perusal.

The applicant undertakes that no open storage will be carried out within the site.

Yours faithfully,  
For and on behalf of  
Goldrich Planners & Surveyors Ltd.



---

Francis LAU

Encl.

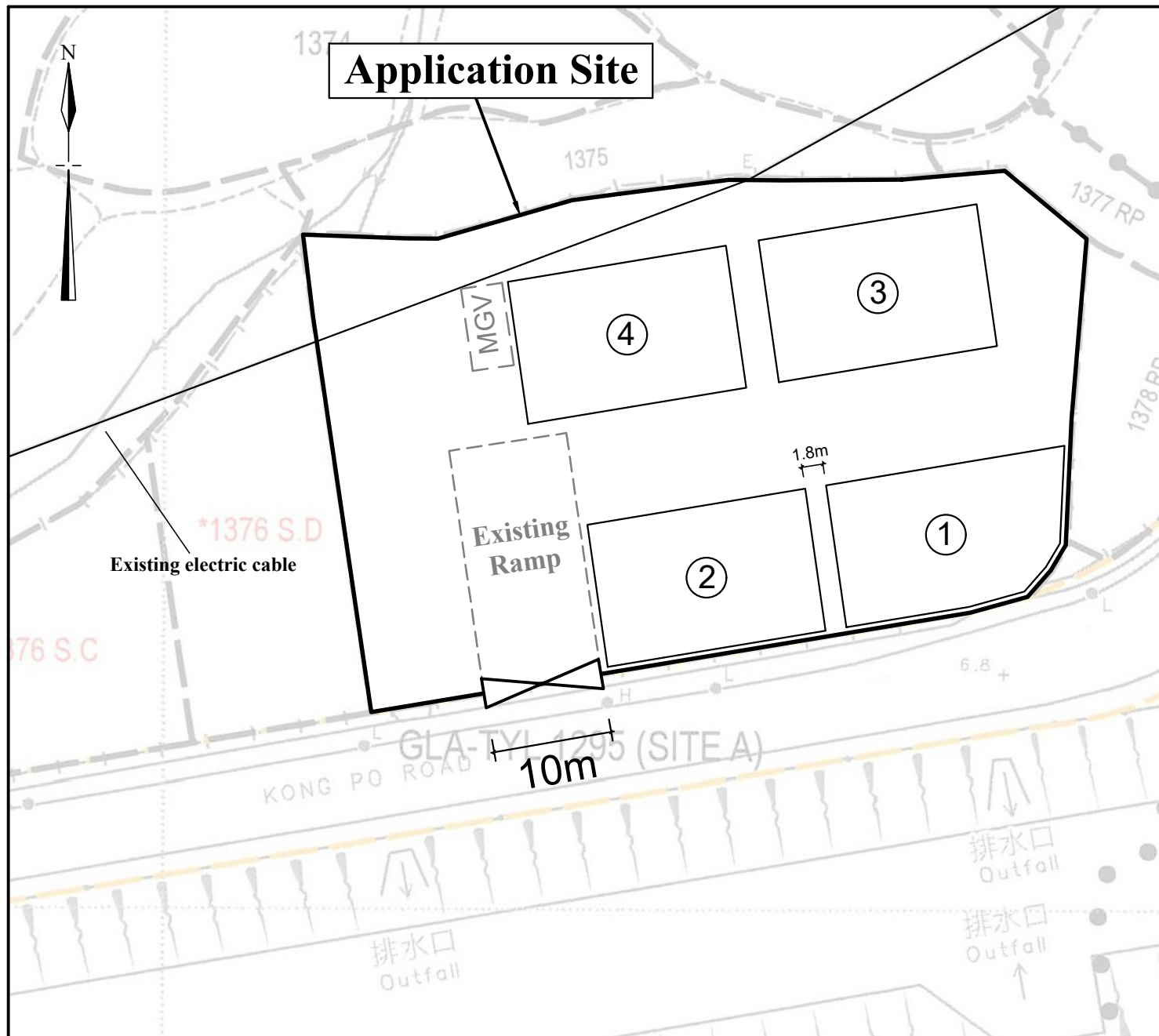

## Legend

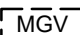
-  Vehicular Ingress / Egress
-  Parking space for medium goods vehicle (7m (L) x 3.5m (W))

Site Area (about): 2,394m<sup>2</sup>

No.	Structure / Use	Floor Area (about)	Covered Area (about)	Height	No. of Storeys
1	Warehouse with Ancillary Office	225m <sup>2</sup>	225m <sup>2</sup>	9m	1
2	Warehouse with Ancillary Office	225m <sup>2</sup>	225m <sup>2</sup>	9m	1
3	Warehouse with Ancillary Office	225m <sup>2</sup>	225m <sup>2</sup>	9m	1
4	Warehouse with Ancillary Office	225m <sup>2</sup>	225m <sup>2</sup>	9m	1
Total		<u>900m<sup>2</sup></u>	<u>900m<sup>2</sup></u>		

1 : 500

## Layout Plan

**Goldrich Planners & Surveyors Ltd.**

February 2025

Lot 1376 RP in D. D. 109  
Yuen Long, New Territories

**Plan 3a**  
**( P 21071 )**



**Application Site**

The remaining area has been paved with concrete at a depth of 0.9m (from 6.9mPD to 7.8mPD) to provide waterproof surface for erection of structures.



This existing ramp has been paved with concrete at a depth of 0.1m to 0.9m to provide waterproof surface for maneuvering.

### Legend

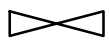

**Vehicular Ingress / Egress**

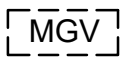

**Parking space for medium goods vehicle  
(7m (L) x 3.5m (W))**

1 : 500

**Plan Showing the Area of Site  
Has Been Paved**

**Goldrich Planners &  
Surveyors Ltd.**

February 2025

Lot 1376 RP in D. D. 109  
Yuen Long, New Territories

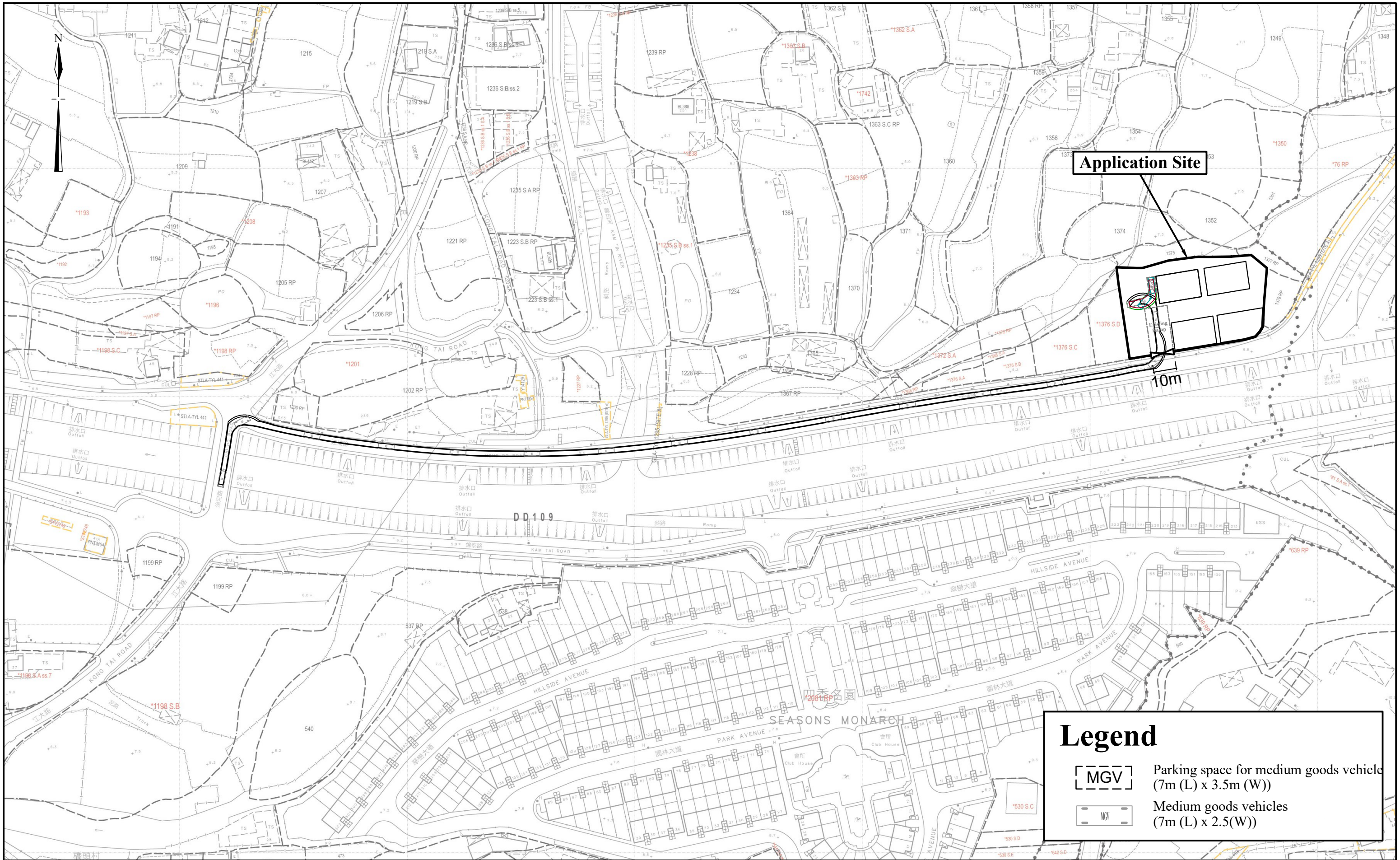

**Plan 4a  
( P 21071 )**



**Application Site**

10m

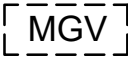
**Legend**

-  Parking space for medium goods vehicle (7m (L) x 3.5m (W))
-  Medium goods vehicles (7m (L) x 2.5(W))

**1:1500 (A3)**

**January 2025**

**Swept Path Analysis**

Lot 1376 RP in D. D. 109  
Yuen Long, New Territories

**Goldrich Planners & Surveyors Ltd.**

**Plan 5a  
( P 21071 )**